

DCNM-FBPW Flush blank panel wide

DICENTIS

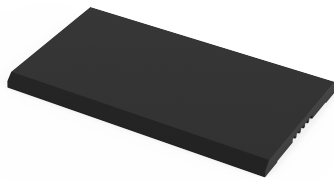

- ▶ Also available in customized colors, wood, stone or metal designs
- ▶ Covers 100 mm slot sizes
- ▶ Stylish and modern design

The blank panel neatly closes off a slot in a flush mounted unit that is not in use. The panel can be removed if a future expansion requires the available slot. Two different panel widths are available.

Parts included

Quantity	Component
10	DCNM-FBPW Flush blank panel wide

Technical specifications

Mechanical

Mounting type	Click-to-fit in a metal panel with a thickness of 2 mm, or in combination with the DCN-FCOUP Flush coupling and the DCNM-FEC Flush end cap in any surrounding
Weight (g)	28 g
Dimensions	56 mm x 100 mm
Color (RAL)	RAL 9017 Traffic black

Environmental

According to IEC 60721: storage (1K3), transportation (2K2) and operational (3K4).

Transportation temperature (°C)	-30 °C – 70 °C
Transportation temperature (°F)	-22 °F – 158 °F
Storage temperature (°C)	-5 °C – 45 °C
Storage temperature (°F)	23 °F – 113 °F
Operating relative humidity, non-condensing (%)	5% – 90%

Ordering information

DCNM-FBPW Flush blank panel wide

Blank panel 100 wide, flush mounted, set of 10.
Order number **DCNM-FBPW | F.01U.393.973**

Represented by:

Europe, Middle East, Africa:
Bosch Security Systems B.V.
P.O. Box 80002
5600 JB Eindhoven, The Netherlands
www.boschsecurity.com/xc/en/contact/
www.boschsecurity.com

Germany:
Bosch Sicherheitssysteme GmbH
Robert-Bosch-Platz 1
D-70839 Gerlingen
www.boschsecurity.com

North America:
Bosch Security Systems, LLC
130 Perinton Parkway
Fairport, New York, 14450, USA
www.boschsecurity.com

Asia-Pacific:
Robert Bosch (SEA) Pte Ltd, Security Systems
11 Bishan Street 21
Singapore 573943
www.boschsecurity.com/xc/en/contact/
www.boschsecurity.com