

Installation

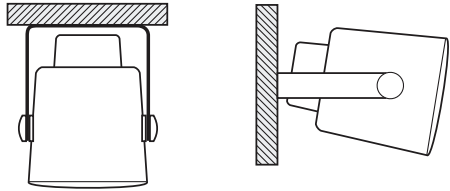

Fig. 1:

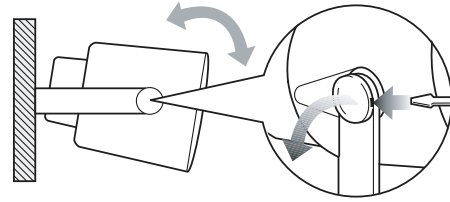

Fig. 2:

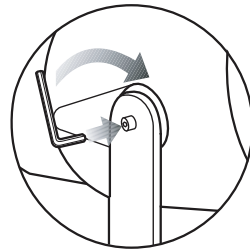

Fig. 3:

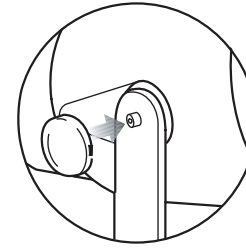

Fig. 4:

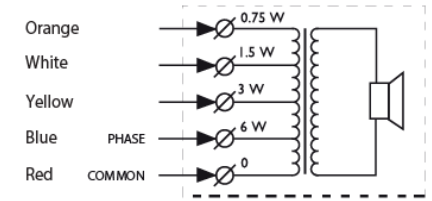

Fig. 5: Circuit diagram

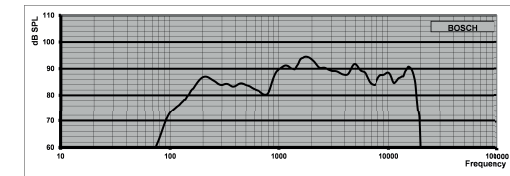

Fig. 6: Frequency response

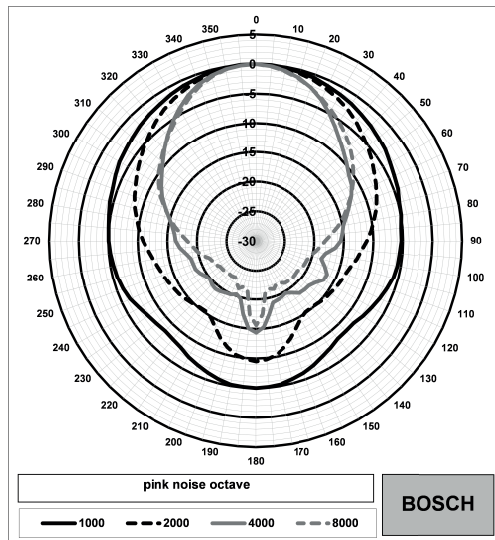

Fig. 7: Polar diagram (high frequency part)

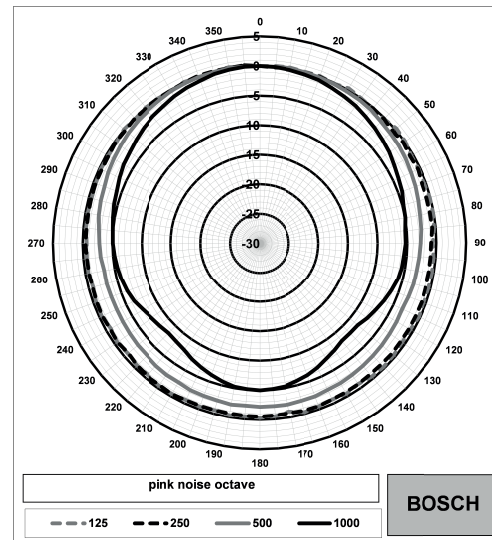

Fig. 8: Polar diagram (low frequency part)

Technical data

Electrical*

Rated power	6 / 3 / 1.5 / 0.75 W
Sound pressure level at 6 W / 1 W (1 kHz, 1 m)	97 dB / 89 dB (SPL)
Sound pressure level at 6 W / 1 W (2 kHz, 1 m)	102 dB / 94 dB (SPL)
Opening angle at 1 kHz / 4 kHz (-6 dB)	180° / 90°
Effective frequency range (-10 dB)	140 Hz to 18 kHz
Rated voltage	100 V
Rated impedance	1667 ohm
Connection	2 m 5-wire cable

* Technical performance data acc. to IEC 60268-5

Mechanical

Dimensions (D x L)	165 x 200 mm (6.50 x 7.87 in)
Speaker diameter	100 mm (4 in)
Weight	1.5 kg (3.3 lb)
Color	White (RAL 9010)
Magnet weight	101 g (3.57 oz)

Environmental

Operating temperature	-25 °C to +55 °C (-13 °F to +131 °F)
Storage and transport temperature	-40 °C to +70 °C (-40 °F to +158 °F)
Relative humidity	<95%



LBC3941/12 Sound projector, 6W



en Installation note