

# PRP-UC15L Cabinet loudspeaker, 15W

## PROSPERO



- ▶ Excellent voice clarity and background music effects
- ▶ For use with PRP-UC15L-IP active IP speakers
- ▶ Rotatable logo for horizontal or vertical wall mounting

The PRP-UC15L is a passive speaker designed for use with the PRP-UC15L-IP active IP speaker. It features a white wooden enclosure and is suitable for indoor applications. High-quality 5.2-inch full-range speaker unit and wooden enclosure with a vented design, delivering excellent voice clarity and background music performance. Rear panel comes with two mounting brackets for either horizontal or vertical wall mounting. Rotatable Bosch logo on front panel to match different mounting orientations.

### Functions

- Used in conjunction with the PRP-UC15-IP active IP speaker, accessed via IP network PROSPERO Public Address System.
- Rotatable front panel logo.
- Mounting brackets included for horizontal or vertical wall mounting options.

### Installation/configuration notes

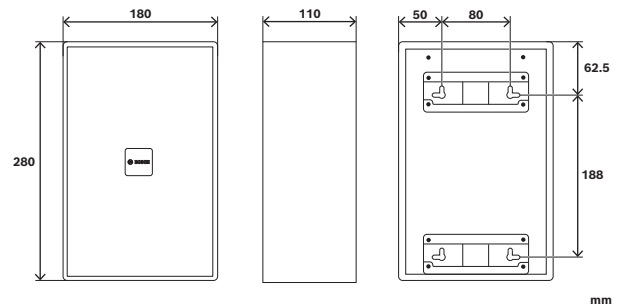

Fig. 1: Front, side and rear view

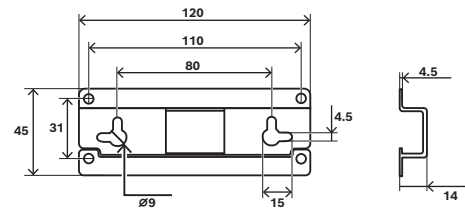
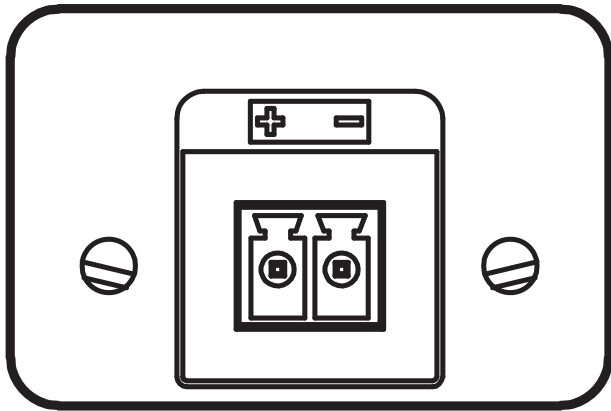

Fig. 2: Bracket dimensions

Rear view



Rear view interconnections



Connects to IP speaker

Parts included

Quantity	Component
1	Cabinet loudspeaker, 15 W
1	Terminal block (set)
1	Safety and user information leaflet

Technical specifications

Electrical

Speaker	
Rated power (W)	15 W, 8 Ω
Sensitivity (1 W, 1 m, 1 kHz octave) (dB)	87 dB
Sound pressure level (rated power, 1 m, 1 kHz octave) (dB)	99 dB
Frequency range (-10 dB) (Hz)	95 Hz – 19.5 kHz
Coverage angle HxV (-6 dB, 1 kHz) (°)	184° x 170°

Speaker

Coverage angle HxV (-6 dB, 4 kHz) (°)	112° x 35°
---------------------------------------	------------

Analog audio input

Type	1x Loudspeaker output
Interface	1x 2-pin Phoenix connector

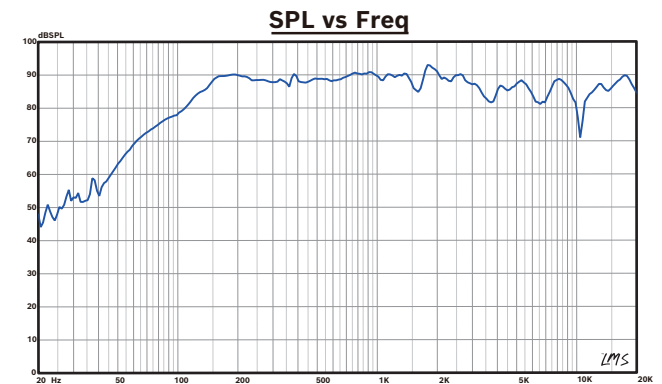

Fig. 3: Frequency response graph

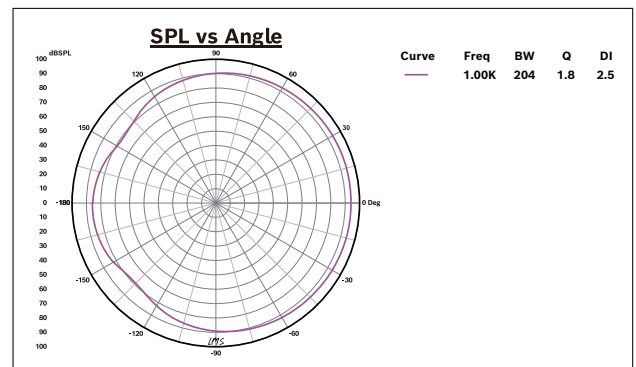

Fig. 4: Polar pattern diagram: 1K vertical directivity

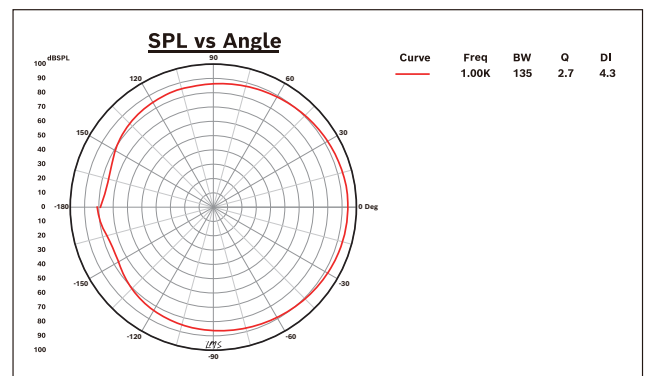

Fig. 5: Polar pattern diagram: 1K horizontal directivity

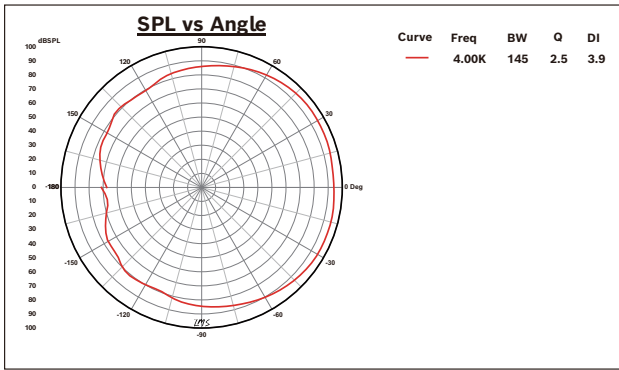

Fig. 6: Polar pattern diagram: 4K vertical directivity

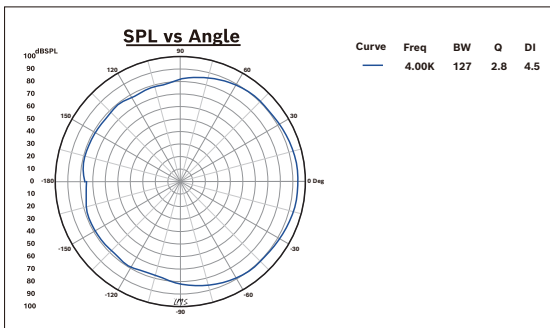

Fig. 7: Polar pattern diagram: 4K horizontal directivity

Operating relative humidity, non-condensing (%) <95%

**Ordering information**

**PRP-UC15L Cabinet loudspeaker, 15W**  
 Passive speaker, 15 W, white wooden enclosure, mounting bracket included.  
 Order number **PRP-UC15L | F.01U.429.440**

**Mechanical**

<b>Speaker</b>	
Material	Wooden case, metal grille
Dimensions (H x W x D)	280 mm x 180 mm x 110 mm
Weight	2300 g
Color (RAL)	RAL 9003 Signal white

<b>Brackets</b>	
Material	Metal
Color (RAL)	RAL 9017 Traffic black
Mounting	Wall-mounted, optional horizontal or vertical orientation

**Environmental**

Operating temperature (°C)	-5°C – 45°C
Storage and transportation temperature (°C)	-40°C – 70 C



<https://www.boschsecurity.com>