

Technical Bulletin

Bosch conventional smoke head magnet test location

Issue severity

- High. Act immediately
- Medium. Bosch Security Systems strongly recommends you take the action described below.
- Low. Advisory

Products affected

- ▶ FCP-350-P
- ▶ FCP-350-PTH

Date

November 8th, 2023

Issue

The reed switch location on the FCP-350-P and FCP-350-PTH smoke detector heads are in a different location than described in the product's installation manual (HA-06-446). The manual describes a position approximately 45 degrees clock-wise to the detector head LED.

Resolution

The correct location of the reed switch is near the **“Do Not Paint”** product marking on the detector head, or approximately 180 degrees to the LED.

Workaround

Place and hold the magnet approximately 180 degrees from the LED position on the detector head in accordance to the GO/NO-GO TESTING procedure found in the installation manual (HA-06-446).

GO/NO-GO Testing procedure:

1. Hold the Test Magnet next to the **“Do Not Paint”** product marking.
2. **Go setting:** Hold the magnet in this position for 13 seconds. The detector alarms with the red LED latched On.
3. **No Go setting:** After 13 seconds, the detector continues to blink red every 3 seconds and never alarm or latch red.

4. Upon reset, the detector LED blinks green every 3 seconds. If the detector blinks red, replace the detector.

Refer to the graphic below for test magnet placement.

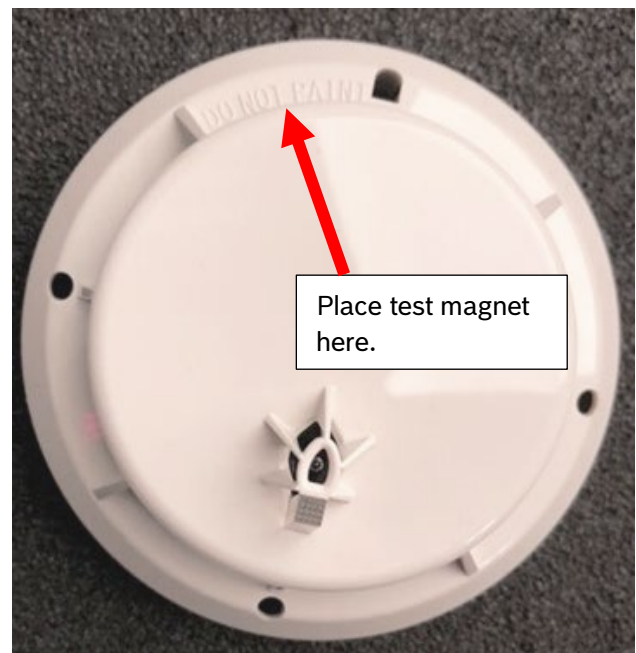

Bosch Security Systems B.V.

Torenallee 49

5617 BA Eindhoven

Netherlands

www.boschsecurity.com

© Bosch Security Systems B.V., 2023